



**Precision
Heavy-Duty
Springs**

MW Components
Greer: Springs



mwcomponents.com

| MW Components. Whatever it takes.

Leading Manufacturers Rely on Springs Produced by MW Components – Greer: Springs

For decades, **MW Components – Greer: Springs**, formerly known as Duer/Carolina Coil, has had a reputation as one of the world's premiere manufacturers of engineered springs. We are constantly working to improve the processes and machinery we use to ensure the products we produce are reliable, safe, and perform to your expectations in even the most challenging environments. From the integrity of our raw materials to our never-ending commitment to continuous improvement, ours is a story of lasting partnership and leading-edge innovation.

What We Offer

- Over 115 Years of Experience
- Many Hot and Cold Coiled Spring Styles
- Max OD of 24", Max FH of 57"
- Customization to Your Exact Specifications
- Advanced Manufacturing & State-of-the-art Equipment
- In-house Coating
- ISO 9001 Certified

Custom Spring Manufacturing Capabilities

- Hot Wound** – Bar Diameter: 0.500" (12.7mm) - 3" (76.2mm)
- Cold Wound** – Wire Diameter: 0.250" (6.4mm) - 0.787" (20mm)



Production to Your Exact Specifications

The key to ensuring spring efficiency and performance relies on our commitment to advanced technology and manufacturing. We have made investments in state-of-the-art bar furnaces and equipment for coiling, heat treatment, testing, grinding, and shot peening, all critical to maintaining the metallurgical and physical properties of our springs. We offer in house powder coating and liquid paint lines for your convenience.

Our facility is also equipped with the latest technology and houses multiple production lines for manufacturing hot and cold wound springs, with computerized load-testing equipment capable of testing loads from 50 pounds (23 kilograms) to 150,000 pounds (68,000 kilograms). By utilizing an advanced continuous manufacturing process, we guarantee product consistency, yielding unmatched metallurgical integrity and extended product life cycle.

Custom Springs

- Compression
- Extension
- Torsion
- Pigtail
- Conical
- Variable Pitch
- Special Configurations

Services

- Hot Coiling & Cold Coiling
- Shot Peening
- Grinding
- Coatings & Surface Treatments
- Cycle Testing
- Magnetic Particle Inspection
- Automated Load Testing
- Custom Tooling
- Engineering & Design Consulting
- Prototyping



Quality Materials Ensure Peak Performance

Our commitment to quality starts with the raw materials we use. Our long-standing relationship with key suppliers ensures that only the best materials are used in the production of your springs. Through state-of-the-art technology and advanced manufacturing processes, we ensure the optimum metallurgical integrity for our products.

Our Commitment to You

At **MW Components – Greer: Springs**, we strive for continuous improvement of our processes and machinery to deliver the most advanced solutions for our customers. By utilizing a continuous manufacturing process, we guarantee product consistency, yielding unmatched reliability.

We are also committed to keeping pace with modern spring technology and exploring new ways to improve our products and processes. By looking to the future, we anticipate the changing needs of our customers which allows us to deliver exactly what you need when you need it. We are proud of our customer retention and work hard to make each customer a customer for life. [Contact us](#) today to discuss how we can help you with your next project.



Springs for Automotive

Performance and Reliability You Can Trust

Whether you are providing springs to restore a classic car, modifying existing ride performance, or lifting a vehicle for off-road use we understand the demands of the ever-changing specialty automotive aftermarket. **MW Components – Greer: Springs** manufactures products built for performance and reliability. From the selection of the highest quality raw materials to our use of state-of-the-art equipment and manufacturing techniques, we ensure optimum integrity for our products, resulting in dependable, continuous operation and consistency from one spring to the next. And our quality assurance program is compliant with ISO 9001, giving you full confidence in our products' performance year after year.

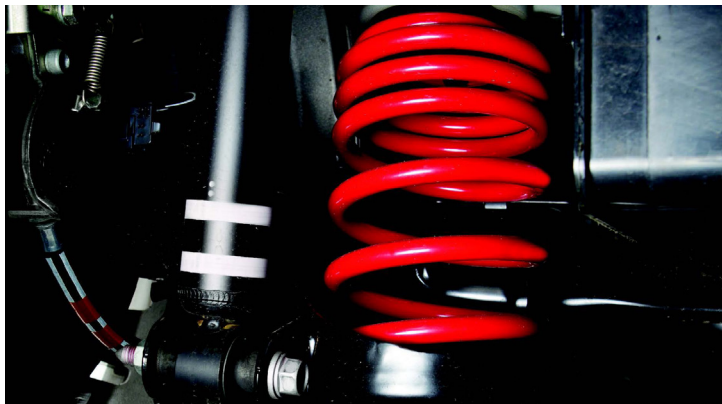

RESTORATION



LOWERING



Springs for Industrial

MW Components – Greer: Springs understands the ever-increasing demand on Industrial applications. Properly designed spring systems contribute to overall performance of key assemblies from actuator assemblies to pipe supports, and more. By utilizing a continuous manufacturing process and using quality materials, we ensure product consistency from spring to spring, resulting in dependable, continuous operation and consistency from one production cycle to the next. Our quality assurance program is also compliant with ISO 9001, giving you full confidence in the quality of our products.

Additionally, our skilled engineering staff is experienced in a variety of nuanced applications and use cases and we put our knowledge and industry experience to work for you. We approach each project with a problem-solving mentality, using our team of experienced engineers to assist with designs and testing. Working with customers, we manufacture to exacting specifications and understand the importance of short-lead times and on-time delivery, allowing you to get your product to market faster.

Industry Experience Meets Engineering Expertise



Process Industries: Ensuring Safety & Reliability

Components like compression springs used inside a valve or actuator assembly need to be reliable, safe, and provide lasting performance. No one understands this more than us. MW Components is one of the world's leading producers of engineered springs used by demanding industries like oil and gas, power generation, and valve suppliers for the nuclear energy market. To start, we acquire the highest

quality steel from the industry's most reputable steel suppliers. We fabricate and test springs as requested to meet the highest industry standards. And through state-of-the-art technology and advanced manufacturing processes, we ensure the optimum metallurgical integrity for our products, resulting in more consistent performance and reliable operations.



Springs for Agriculture

Peak Performance in Extreme Conditions

The variety of modern tillage practices that are used to reduce soil compaction, improve pore space, and decrease soil loss demands the highest quality coil springs for season after season of durable performance. At **MW Components – Greer: Springs**, we fabricate and test springs as requested to meet the highest industry standards. Through state-of-the-art technology and advanced manufacturing processes, we ensure the optimum integrity for our products, resulting in more dependable, consistent performance over millions of cycles. Our quality assurance program is compliant with ISO 9001, giving you full confidence in the quality of the products we supply from the first production run to the thousandth.

Maximize Service Life in Agricultural Applications



Springs for Mining

Demanding Environments Demand Performance

With extreme loads and high-frequency oscillation, mining, construction, and heavy-duty equipment demand performance above and beyond many applications.

At **MW Components – Greer: Springs**, we understand your unique needs. That's why we work directly with your teams, keeping your necessary tolerances, certifications, and application requirements in mind. From the selection of the highest quality raw materials to our use of state-of-the-art equipment and manufacturing techniques, we ensure optimum performance and cycle life of our products. And our quality assurance program is compliant with ISO 9001, giving you full confidence in our products' performance cycle after cycle and year after year.

Improve Spring Performance and Cycle Life



Other MW Components Products & Services

MW Components – Greer: Springs is one of more than 20 US-based manufacturing facilities across the **MW Components** network. Our facilities manufacture a range of stock and custom parts from springs and fasteners to bellows, couplings, shims, and many other precision metal components. Our components are found in more than 15 industries including automotive, aerospace, construction, medical, energy, electronics, semiconductor, and more.

To shop MW Components products or review or request services, visit [MWComponents.com](https://www.mwcomponents.com).

Products

- Coiled Springs
- Machined Springs
- Belleville Washers / Disc Springs
- Fasteners & Pins
- Electroforms
- Electrical Contacts
- Bellows
- Couplings & U-Joints
- Die Manufacturing
- Retaining Rings
- Stampings
- Wire Forms
- Shims

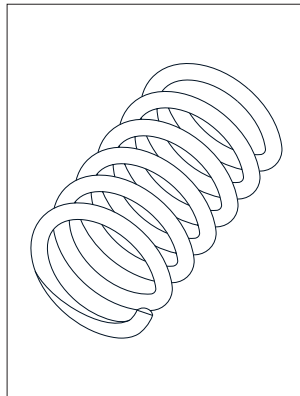

| Springs

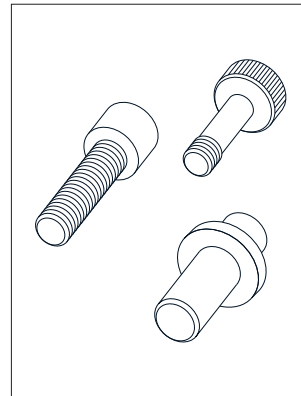

| Fasteners

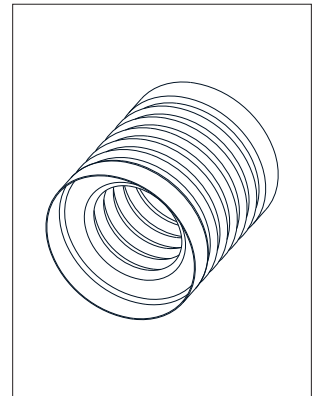

| Bellows

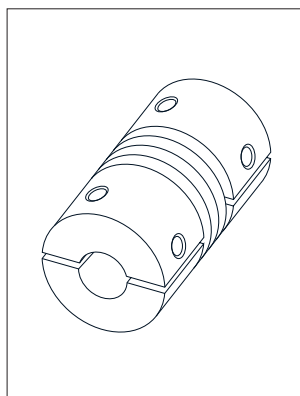

| Couplings

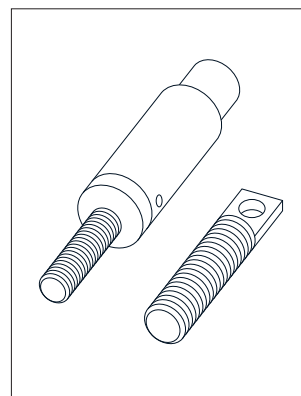

| Precision Components

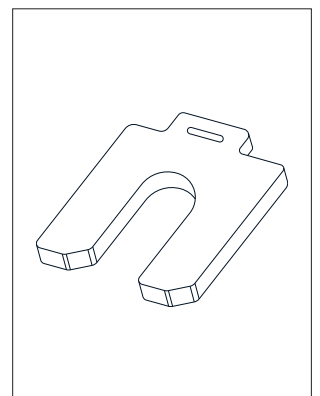

| Shims



Services

- Machining
- Stamping & Forming
- Finishing (Coatings, Surface Treatments, Etc.)
- Design & Engineering Support
- Prototyping
- Tooling
- Performance Analysis & Testing
- Assembly
- Inventory Control
- Custom Packaging



MW Components. Whatever it takes.



About MW Components

MW Components is focused on accelerating the entire process of delivering custom, stock, and standard parts to virtually any volume and against demanding deadlines. We work to highly complex tolerances. We help simplify the management of any number of different components. And we take a no-compromise approach to quality. With MW Components, you can be sure you'll get the right part to the right specification when and where you need it.

MW Components. Whatever it takes.

MWComponents.com